

TWL

TWOK LIFT

TWOK LIFT

TWL

TWOK LIFT

TWOK LIFT

Bu tip gazlı amortisörler yük ve ağırlıkları eş kuvvet ile dengeler ve kullanım alanında konfor sağlar. Lift tipi gazlı amortisörlerimiz yüklerin kaldırma, dengeleme, yana yatırma ve frenlemesi ile ilgili dünyanın en yüksek standartlarını karşılamaktadır.

This type of gas springs is used as a counterbalance of weights and as speed control devices. They meet the highest worldwide standards for lifting, counter-balancing, lowering, tilting and damping lids and covers.

Detaylı Özellikler / Advance Features

- **Yük kaldırma / Load Lifting**
- **A min - A max** | 10 - 700 mm
- **L min - L max** | 80 - 1500 mm
- **F min - F max** | 50 - 2500 N
- **Malzeme / Material** | Paslanmaz Çelik / Stainless steel
- **Yüzey / Surface** | Siyah Boya / Black Paint
- **Renk / Colour** | Siyah / Black (standart)
- **Çalışma sıcaklığı / Working temperature** | -30° / +80° (standart)
- **Mil / Mil** | Lütfen iletişime geçin / Please contact with us
- **Başlık / Piston Connection** | Lütfen iletişime geçin / Please contact with us
- **Kullanım Mekanizması / Usage mechanism** | Lütfen iletişime geçin / Please contact with us
- **Damperleme / Damping** | Lütfen iletişime geçin / Please contact with us
- **Açılış Hızı / Opening speed** | Lütfen iletişime geçin / Please contact with us

*Özel kullanım için lütfen irtibata geçiniz
/ *Please get in contact for special requests

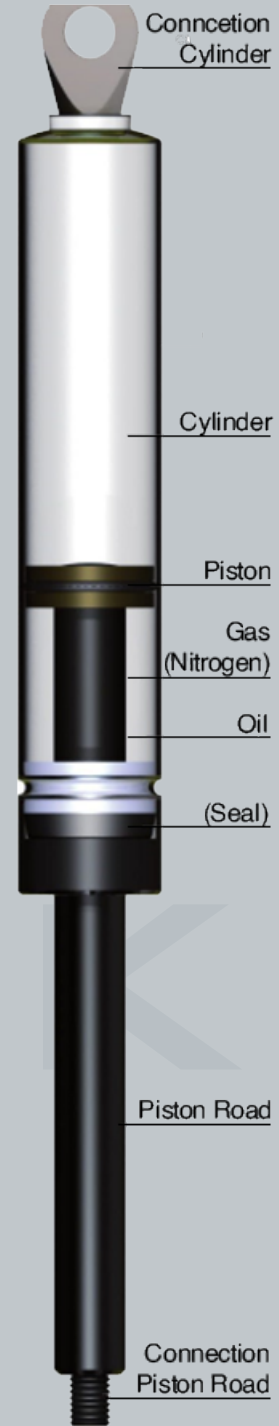

Önemli Not / Important Notices

TWL bir emniyet parçası değildir. / TWL is not a safety part.

TWL, konumu ayarlanabilir mobilyalar, ekipmanlar ve türevleri için dizayn edilmiştir. Öngörülen uygulama alanları dışında kullanımda meydana gelebilecek herhangi bir tehlike ve/veya maddi hasar için sorumluluk firmamıza ait değildir. / Our adjustable fittings are designed for use in adjustable furnitures, equipments or similar purposes. We do not accept any responsibility with respect to security risks caused by any applications other than described above nor for any unspecified application.

GAZLI LIFT GAS SPRING

L : AÇIK BOY / OPEN LENGHT

A : KURS / STROKE

D2 : PİSTON ÇAPI / PISTON ROD DIAMETER

D1 : TÜP ÇAPI / TUBE DIAMETER

L : AÇIK BOY / OPEN LENGHT

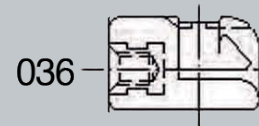
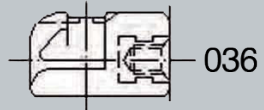
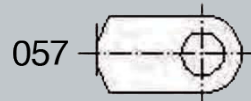
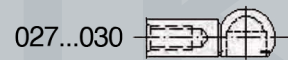
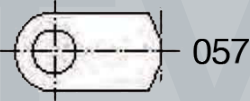
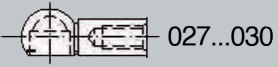
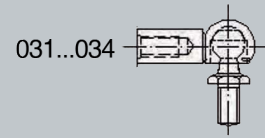
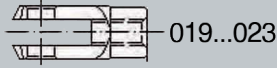
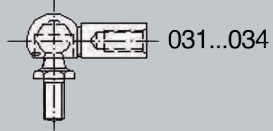
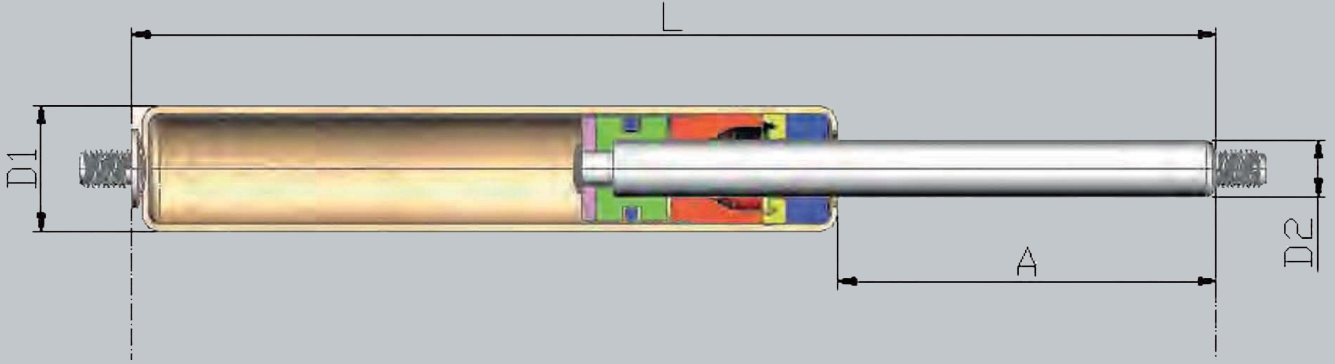

TYPE		L		A		F	
D1	D2	Min.	Max.	Min.	Max.	Min.	Max.
15	06	80	445	20	200	50	400
18	08	90	855	20	400	50	800
22	10	150	1060	40	500	100	1400
27	14	250	1500	50	700	150	1500
28	14	300	1500	50	700	150	2500

PASLANMAZ LIFT

STAINLESS STEEL GAS SPRING

L : AÇIK BOY / OPEN LENGHT

A : KURS / STROKE

D2 : PİSTON ÇAPI / PISTON ROD DIAMETERLENGHT

D1 : TÜP ÇAPI / TUBE DIAMETERLENGHT

L : AÇIK BOY / OPEN LENGHT

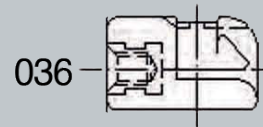
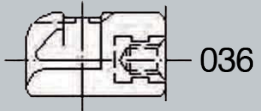
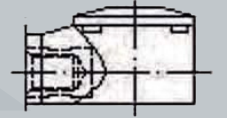
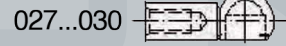
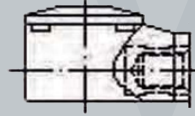
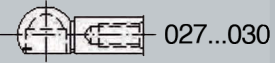
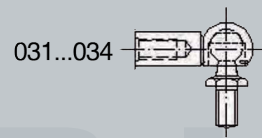
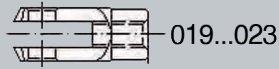
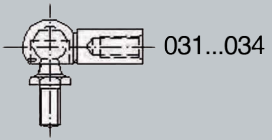
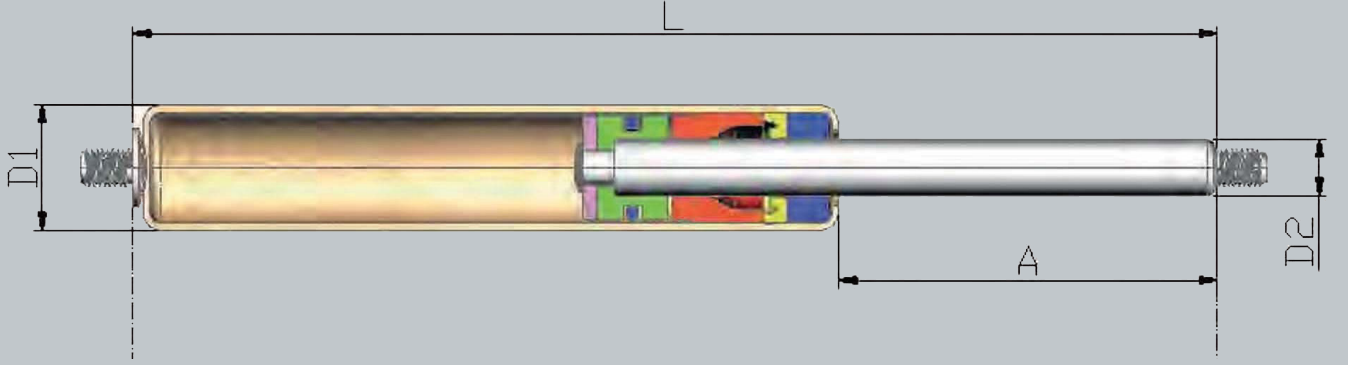

TYPE		L		A		F	
D1	D2	Min.	Max.	Min.	Max.	Min.	Max.
15	06	90	400	20	150	50	350
18	08	100	700	25	300	50	700
21	10	150	900	40	400	100	1200
27	14	250	1500	50	700	250	2500

BASINCI AYARLANABİLİR PASLANMAZ LİFT

ADJUSTABLE PRESSURE
STAINLESS GAS SPRING

L : AÇIK BOY / OPEN LENGTH

A : KURS / STROKE

D2 : PİSTON ÇAPI / PISTON ROD DIAMETERLENGTH

D1 : TÜP ÇAPI / TUBE DIAMETERLENGTH

L : AÇIK BOY / OPEN LENGTH

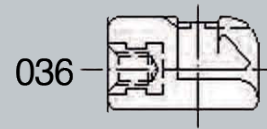
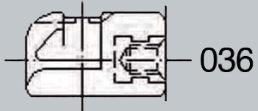
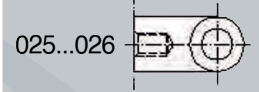
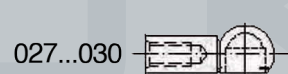
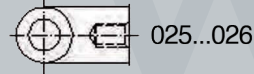
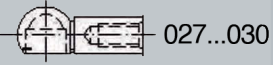
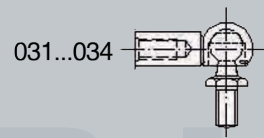
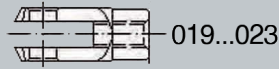
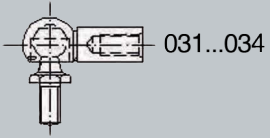
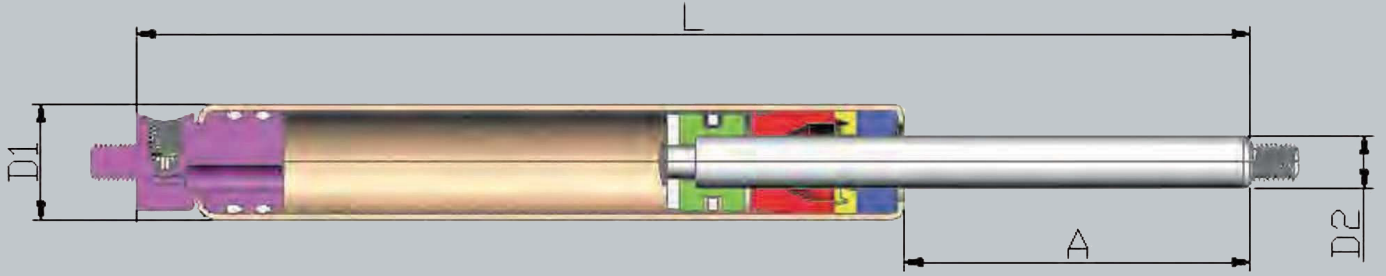

TYPE		L		A		F	
D1	D2	Min.	Max.	Min.	Max.	Min.	Max.
15	06	90	400	20	150	50	350
18	08	100	700	25	300	50	700
21	10	150	900	40	400	100	1200
27	14	250	1500	50	700	250	2500

KİLİTLEME TÜPLÜ LİFT

GAS SPRING WITH LOCKING TUBE

L : AÇIK BOY / OPEN LENGTH

A : KURS / STROKE

D2 : PİSTON ÇAPI / PISTON ROD DIAMETERLENGTH

D1 : TÜP ÇAPI / TUBE DIAMETERLENGTH

L : AÇIK BOY / OPEN LENGTH

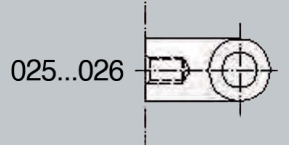
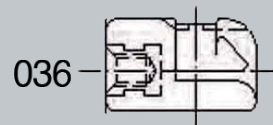
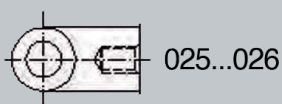
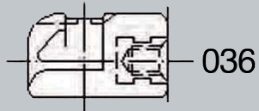
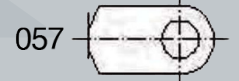
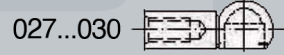
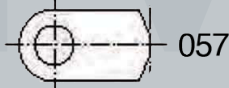
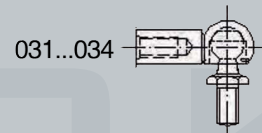
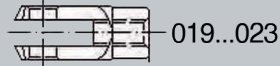
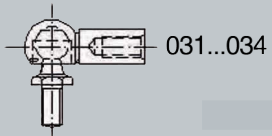
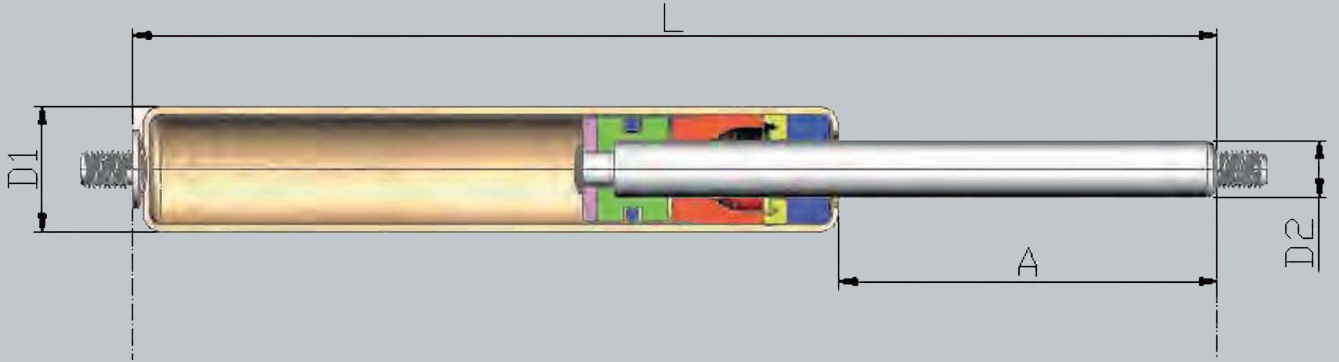

TYPE		L		A		F	
D1	D2	Min.	Max.	Min.	Max.	Min.	Max.
15	06	90	400	20	150	50	350
18	08	100	700	25	300	50	700
21	10	150	900	40	400	100	1200
27	14	250	1500	50	700	250	2500
27	14	250	1500	50	700	250	2500

OZEL TIP (POZİSYONDAN BAĞIMSIZ MONTAJLAMA

SPECIAL TYPE (POSITON FREE MOUNTING)

L : AÇIK BOY / OPEN LENGHT

A : KURS / STROKE

D2 : PİSTON ÇAPI / PISTON ROD DIAMETERLENGHT

D1 : TÜP ÇAPI / TUBE DIAMETERLENGHT

L : AÇIK BOY / OPEN LENGHT

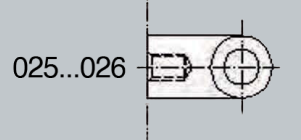
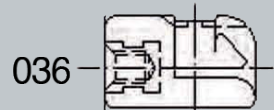
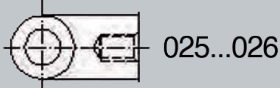
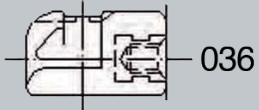
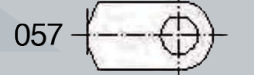
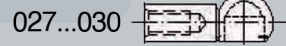
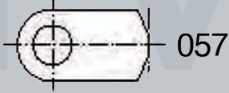
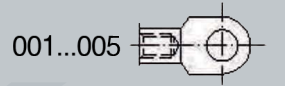
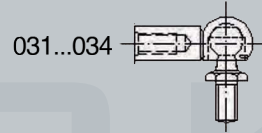
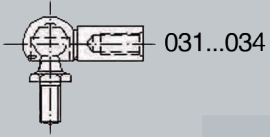
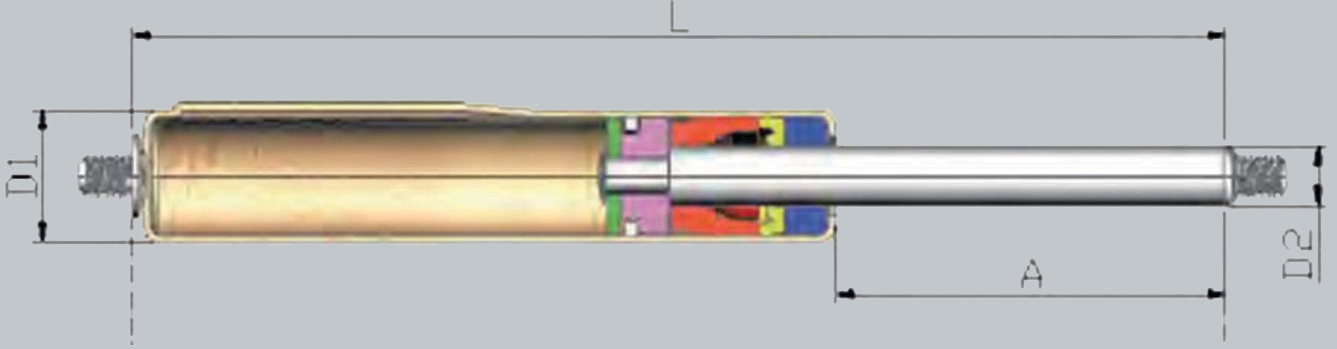

TYPE		L		A		F	
D1	D2	Min.	Max.	Min.	Max.	Min.	Max.
15	06	90	400	20	150	50	350
18	08	100	700	25	300	50	700
22	10	150	900	40	400	100	1200
27	14	250	1500	50	700	250	2500

BASINCI AYARLANABİLİR LIFT

ADJUSTABLE PRESSURE GAS SPRING

L : AÇIK BOY / OPEN LENGHT

A : KURS / STROKE

D2 : PİSTON ÇAPI / PISTON ROD DIAMETERLENGHT

D1 : TÜP ÇAPI / TUBE DIAMETERLENGHT

L : AÇIK BOY / OPEN LENGHT

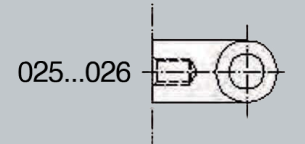
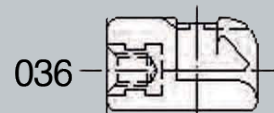
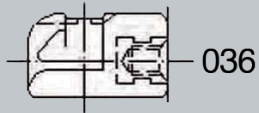
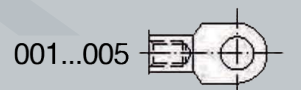
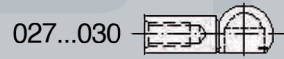
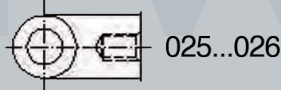
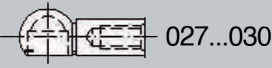
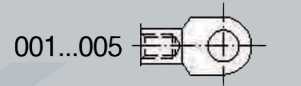
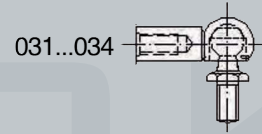
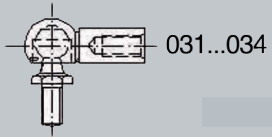
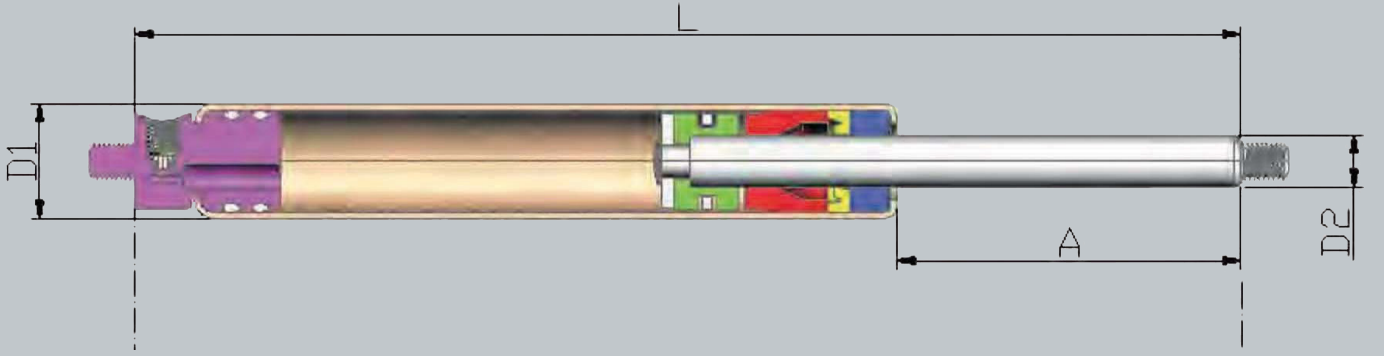

TYPE		L		A		F	
D1	D2	Min.	Max.	Min.	Max.	Min.	Max.
15	06	90	400	20	150	50	350
18	08	100	700	25	300	50	700
22	10	150	900	40	400	100	1200
27	14	250	1500	50	700	250	1200
28	14	300	1500	50	700	1000	2500

SÜRTÜNME DENGELİ LİFT

TRACTION GAS SPRING

L : AÇIK BOY / OPEN LENGHT

A : KURS / STROKE

D2 : PİSTON ÇAPI / PISTON ROD DIAMETERLENGHT

D1 : TÜP ÇAPI / TUBE DIAMETERLENGHT

L : AÇIK BOY / OPEN LENGHT

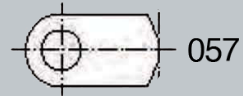
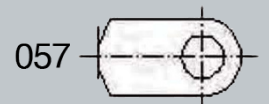
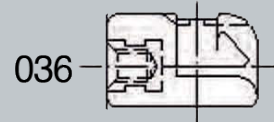
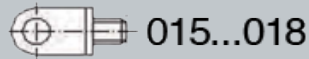
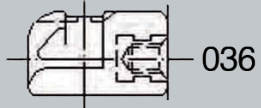
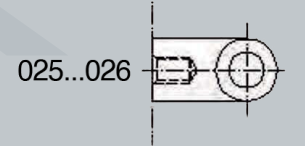
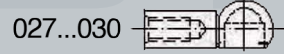
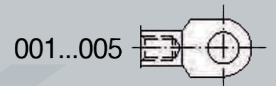
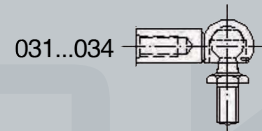
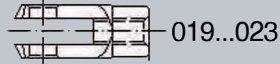
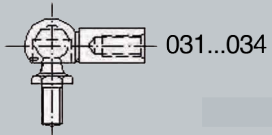
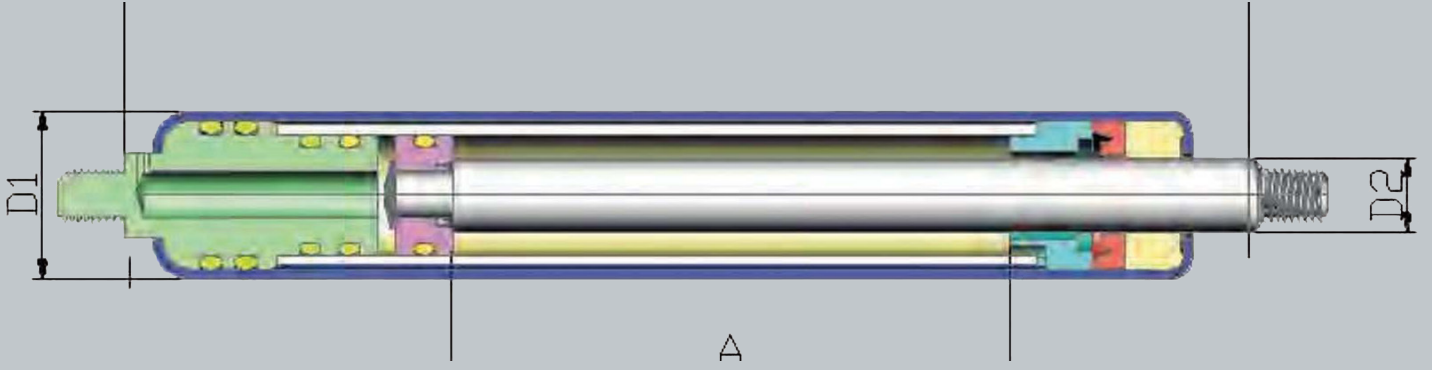

TYPE		L		A		F	
D1	D2	Min.	Max.	Min.	Max.	Min.	Max.
18	08	100	700	25	300	50	700
22	10	150	900	40	400	100	1200
27	10	250	1000	50	400	250	1500

STANDART DIŐI LİFT**SPECIAL GAS SPRING**

L : AÇIK BOY / OPEN LENGHT

A : KURS / STROKE

D2 : PİSTON ÇAPI / PISTON ROD DIAMETERLENGHT

D1 : TÜP ÇAPI / TUBE DIAMETERLENGHT

L : AÇIK BOY / OPEN LENGHT

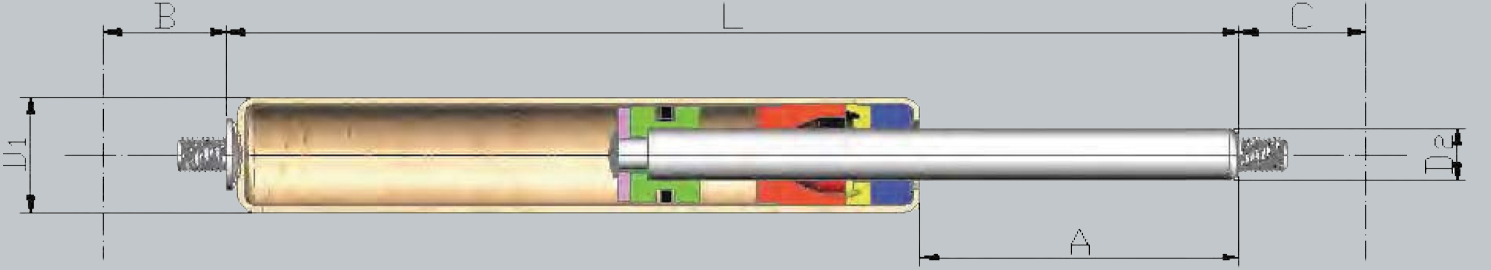

TYPE		L		A		F	
D1	D2	Min.	Max.	Min.	Max.	Min.	Max.
15	06	90	400	20	150	50	350
18	08	100	700	25	300	50	700
22	10	150	900	40	400	100	1200
27	14	250	1000	50	700	250	1500
28	14	300	1000	50	700	1000	2500

BAĞLANTILAR

CONNECTIONS

001

B	K
6,2	5
6,2	10
8,2	5
8,2	10

M5 or M6

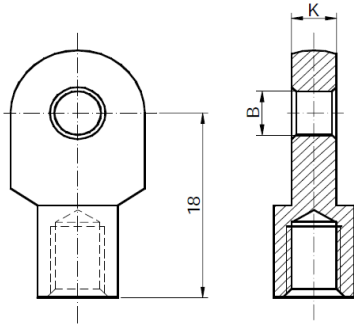

002

B	K
6,2	5
6,2	10
8,2	5
8,2	10

M5 or M6

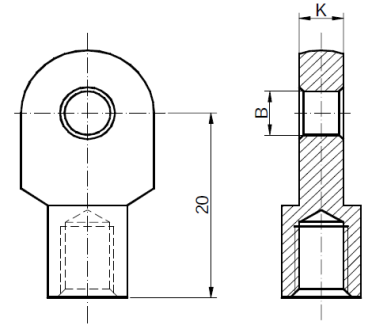

003

B	K
6,2	5
6,2	10
8,2	5
8,2	10
10,2	5
10,2	10

M6 or M8

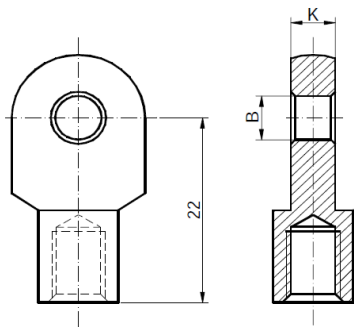

004

B	K
6,2	5
6,2	10
8,2	5
8,2	10
10,2	5
10,2	10

M6 or M8

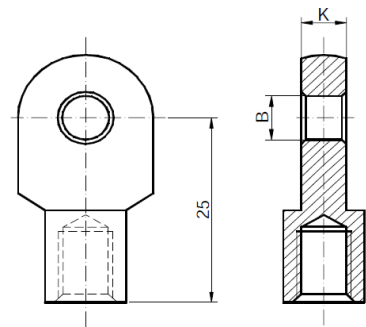

005

B	K
6,2	5
6,2	10
8,2	5
8,2	10
10,2	5
10,2	10

M6 or M8

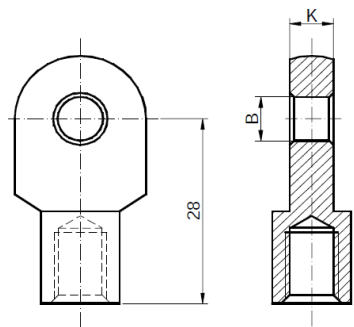

006

C	B
6,2	8
6,2	10
6,2	12
8,2	8
8,2	10
8,2	12
10,2	8
10,2	10
10,2	12

M6 or M8

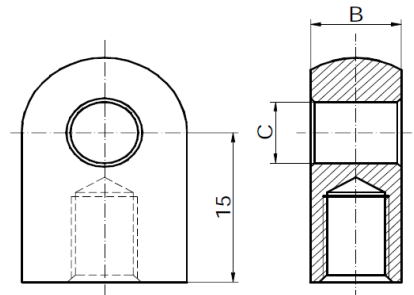

007

C	B
6,2	8
6,2	10
6,2	12
8,2	8
8,2	10
8,2	12
10,2	8
10,2	10
10,2	12

M6 or M8

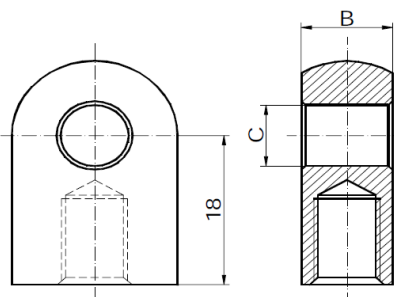

008

C	B
6,2	8
6,2	10
6,2	12
8,2	8
8,2	10
8,2	12
10,2	8
10,2	10
10,2	12

M6 or M8

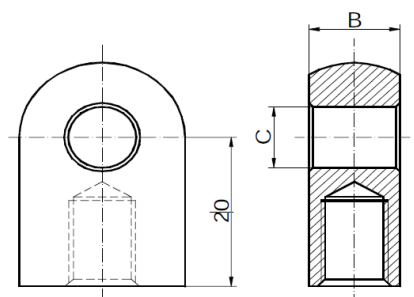

009

B	K
6,2	5
6,2	10
8,2	5
8,2	10

M5 or M6

010

B	K
6,2	5
6,2	10
8,2	5
8,2	10

M6 or M8

011

B	K
6,2	5
6,2	10
8,2	5
8,2	10
10,2	5
10,2	10

M5 or M6

012

B	K
6,2	5
6,2	10
8,2	5
8,2	10
10,2	5
10,2	10

M5 or M6

013

B	K
6,2	5
6,2	10
8,2	5
8,2	10
10,2	5
10,2	10

M5 or M6

014

M6

015

M10x1,5

016

B	K
6,2	5
6,2	8
6,2	10
8,2	5
8,2	8
8,2	10
10,2	8
10,2	10
10,2	12

M 10x1,5

017

B	K
8,2	10
8,2	12
10,2	10
10,2	12
13,2	10
13,2	12

M 10x1,5

018

B	K
8,2	10
8,2	12
10,2	10
10,2	12
13,2	10
13,2	12

M 10x1,5

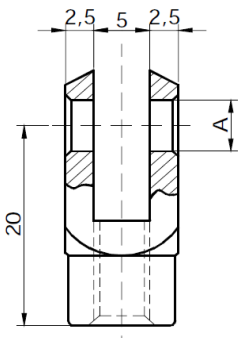
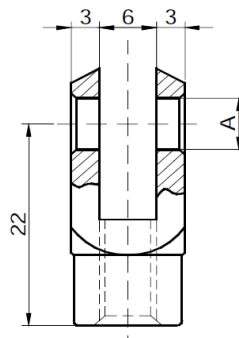
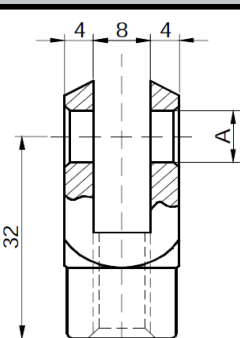
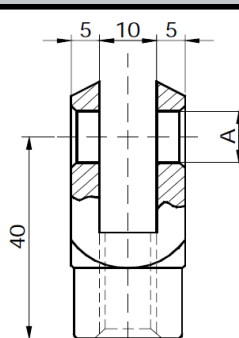
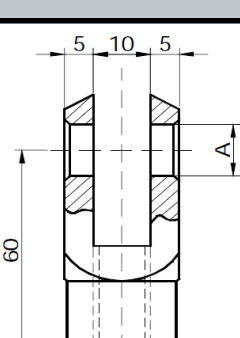
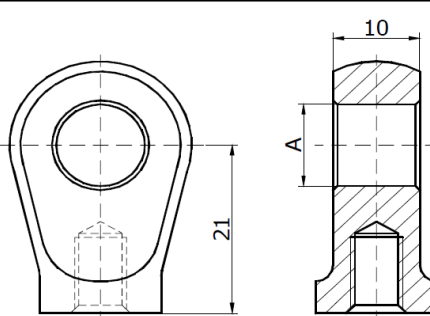
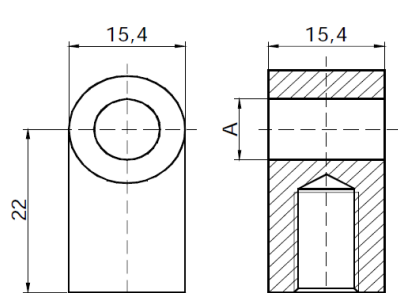
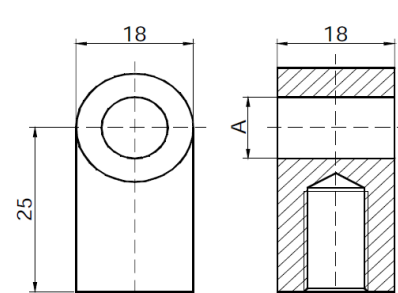
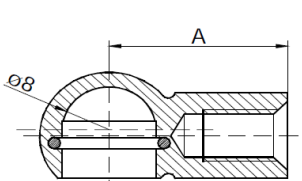
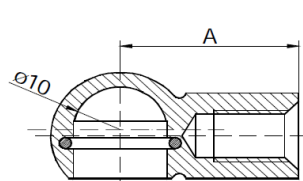
<p>019</p> <table border="1"> <tr><td>A</td></tr> <tr><td>5,2</td></tr> <tr><td>6,2</td></tr> </table> <p>M6 or M8</p> 	A	5,2	6,2	<p>020</p> <table border="1"> <tr><td>A</td></tr> <tr><td>5,2</td></tr> <tr><td>6,2</td></tr> </table> <p>M6 or M8</p> 	A	5,2	6,2	
A								
5,2								
6,2								
A								
5,2								
6,2								
<p>021</p> <table border="1"> <tr><td>A</td></tr> <tr><td>6,2</td></tr> <tr><td>8,2</td></tr> </table> <p>M6 or M8</p> 	A	6,2	8,2	<p>022</p> <table border="1"> <tr><td>A</td></tr> <tr><td>8,2</td></tr> <tr><td>10,2</td></tr> </table> <p>M8 or M10</p> 	A	8,2	10,2	
A								
6,2								
8,2								
A								
8,2								
10,2								
<p>023</p> <table border="1"> <tr><td>A</td></tr> <tr><td>8,2</td></tr> <tr><td>10,2</td></tr> </table> <p>M10</p> 	A	8,2	10,2	<p>024</p> <table border="1"> <tr><td>A</td></tr> <tr><td>6,2</td></tr> <tr><td>8,2</td></tr> <tr><td>10,2</td></tr> </table> <p>M6 or M8</p> 	A	6,2	8,2	10,2
A								
8,2								
10,2								
A								
6,2								
8,2								
10,2								
<p>025</p> <table border="1"> <tr><td>A</td></tr> <tr><td>5,2</td></tr> <tr><td>6,2</td></tr> </table> <p>M6 or M8</p> 	A	5,2	6,2	<p>026</p> <table border="1"> <tr><td>A</td></tr> <tr><td>8,2</td></tr> <tr><td>8,5</td></tr> <tr><td>10,2</td></tr> </table> <p>M8</p> 	A	8,2	8,5	10,2
A								
5,2								
6,2								
A								
8,2								
8,5								
10,2								
<p>027</p> <table border="1"> <tr><td>A</td></tr> <tr><td>18</td></tr> <tr><td>22</td></tr> </table> <p>M5 or M6</p> 	A	18	22	<p>028</p> <table border="1"> <tr><td>A</td></tr> <tr><td>19</td></tr> <tr><td>22</td></tr> <tr><td>25</td></tr> </table> <p>M6 or M8</p> 	A	19	22	25
A								
18								
22								
A								
19								
22								
25								

029

A
25
30

M8 or M10

030

A
30
35

M8 or M10

031

B	C	D
18	M5	10
18	M6	11
18	M8	13
22	M5	10
22	M6	11
22	M8	13

M5 or M6

032

B	C	D
19	M5	10
19	M6	11
19	M8	13
22	M5	10
22	M6	11
22	M8	13
25	M5	10
25	M6	11
25	M8	13

M6 or M8

033

B	C	D
25	M8	13
25	M8	16,5
25	M10	20
30	M8	13
30	M8	16,5
30	M10	20

M6 or M8

034

B	C	D
30	M10	20
30	3/8"	19
35	M10	20
35	3/8"	19

M8 or M10

035

M5 or M6

036

A	B
M5	10
M6	11
M8	13

M5 or M6

037

M5 or M6

038

A	B
M5	10
M6	11
M8	13

M5 or M6

